

LOAD WEIGHING DEVICE

WLWD, WLWD-M



EXCELLENCE IN COMPONENTS

LOAD WEIGHING DEVICE

WLWD, WLWD-M

FEATURES OF WLWD03, WLWD06

- designed for Wittur car frame series WCF and WLF
- standard supply voltage is 24 VDC
- the outputs are either 24V open collector switching (empty, full load, over load) and also voltage (from -10 to +10V) and current outputs (from 0 to 20 mA)
- the amplifier is available in protection class IP20 and IP54
- small mounting dimensions
- wide range of applications
- pre-arranged to connect to box 87208G02 (central unit for 110/230 VAC supply)

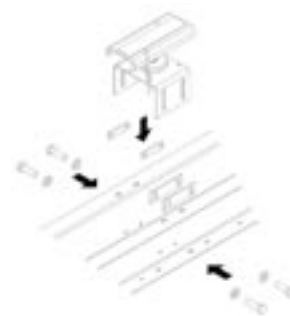
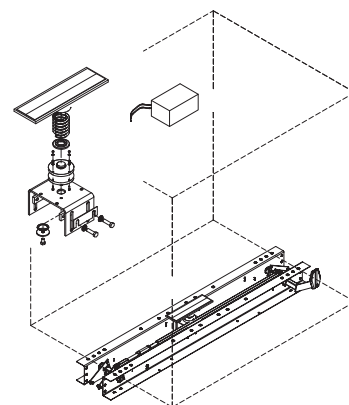

FEATURES OF WLWD-M

- universal system, especially for modernization
- the normal supply voltage is 24 VDC
- the outputs are either 24V open collector switching (empty, full load, over load) or current outputs (from 0 to 20 mA) proportional to measured load
- by using an additional board it is possible to supply the electronic with 230 V/AC. The switching outputs (empty, full load, over load) are relay contacts in this case
- small mounting dimensions
- wide range of applications, because independent from load
- protection class IP20

